

monster & bear STUDIOS

PRODUCER

PACK

# CONTENTS

---

ESSENTIAL INFO	P3
MAIN STUDIO FLOOR PLAN	P4
SOUND STUDIO/GREENROOM FLOOR PLAN	P5
STUDIO FEATURE IMAGE GALLERY	P6
RATE CARD	P7
AVAILABLE EQUIPMENT	P8
HOUSEKEEPING	P9
LOCAL AMENITIES	P10
MEET THE TEAM	P11

---

# ESSENTIAL INFO

EXTERIOR



**STUDIO MANAGER PHONE [SHANNYN]**

**MOBILE** (+61) 0475 777 533 **OFFICE** (03) 8590 3052

**ADDRESS**

MONSTER & BEAR STUDIOS  
13-19 Leslie St, Brunswick VIC 3056, Australia

**WI-FI**

NETWORK: MBSTUDIOS  
PASSWORD: monster1319

**PARKING**

8 vehicle all day parking is available on-site (4 rows of 2-car tandem parking), 2 hour street side parking available along Leslie Street. Further street parking available on Albert Street and Victoria Street. Paid parking available nearby at Woolworths on Albert Street also (a short stroll).

**TRANSPORT**

**TRAIN:** Brunswick Station / Upfield Line  
3 minute walk / 270m  
**TRAM:** Cnr Albert St & Sydney Rd / 19 tram  
5 minute walk / 400m

**PLEASE DIAL 000 IN AN EMERGENCY**

**HOSPITAL**

**ROYAL MELBOURNE HOSPITAL**  
300 Grattan St, Parkville 3052 | 9342 7009

**POLICE**

**BRUNSWICK POLICE STATION**  
630 Sydney Rd, Brunswick 3056 | 8378 6000

# MAIN STUDIO FLOOR PLAN

The main warehouse and studio space at Monster & Bear Studios contains a 10m x 10m two-walled cyclorama with roller door access. This is the main hireable space, and makes up the majority of the floor plan at Monster & Bear Studios. It's a large space, designed to canvas the many creative ideas of those who pass through, as seen by our llama for scale!

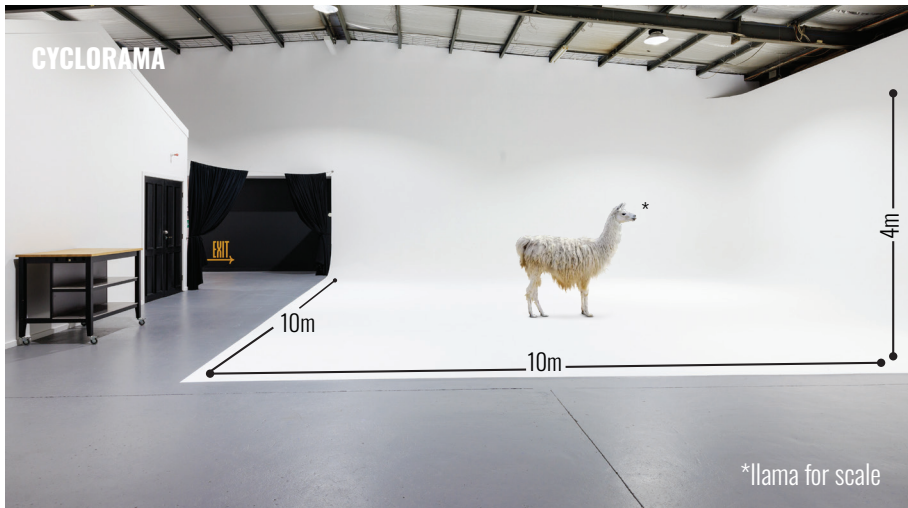
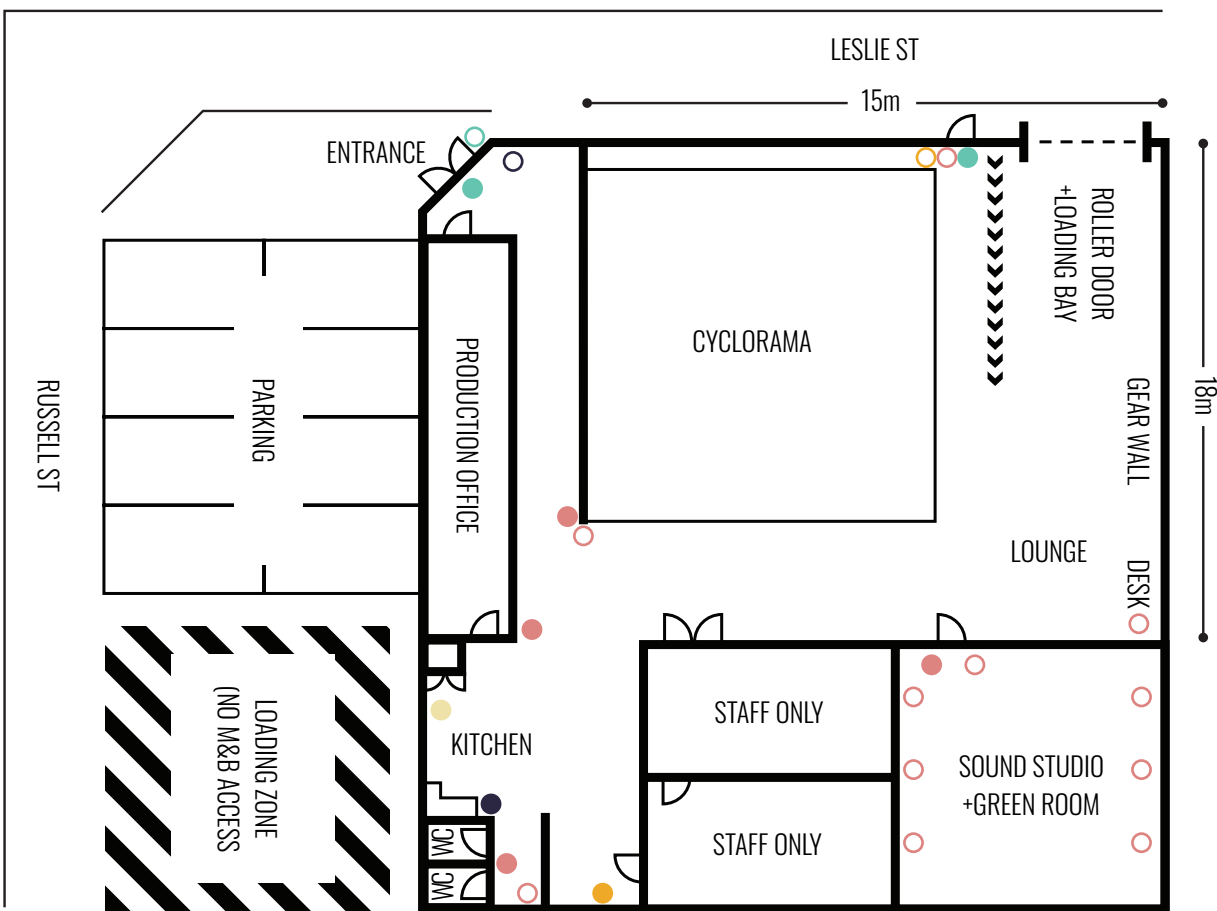

**LEGEND**

- FIRE EXTINGUISHER
- FIRST AID
- RUBBISH/RECYCLING
- LIGHT SWITCH
- EMERGENCY EXIT
- LOCKBOX/KEY
- POWER OUTLET
- 3-PHASE POWER OUTLET
- ALARM SYSTEM

# SOUND STUDIO /GREENROOM

Just off to the side of the main cyclorama space, Monster & Bear Studios also offer the option of booking a 6.5m x 7m sound-treated and climate controlled multi-purpose room. This smaller studio can either be booked on its own (ideal for interviews and smaller shoots with audio required) or in conjunction with cyclorama bookings (often used as a green room, client area, or changing space).



## ROOM FEATURES

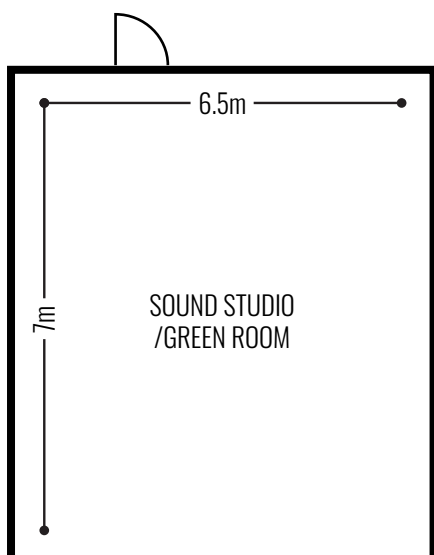

---

Sound treated room with padded walls and acoustic insulation

---

2.7m high ceiling

---

Rear white wall (flat)

---

Heating/cooling

---

Padded flooring for long-stand comfort

---

Makeup table, free-standing lights and high stools

---





Onsite tandem parking (up to 8 spots)

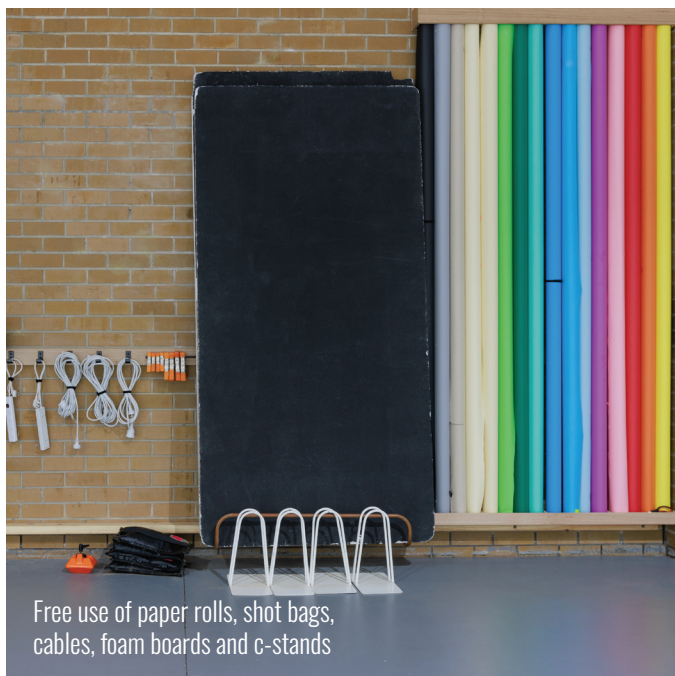

Free use of paper rolls, shot bags, cables, foam boards and c-stands



6 seater kitchen bench and meal space



Coffee machine



Same level roller door access for bump in



Client seating area and workspace

# RATE CARD

Below is a breakdown of studio hire rates and the available add-ons we have, designed to accommodate your shoot flexibly. Something not on the list? Swing the Studio Manager an ask. We're always happy to try and accommodate.

## MAIN STUDIO

By booking the main studio, we add in the Green Room as a complimentary bonus to your shoot

<b>HALF DAY</b> [8AM—12PM OR 2PM—6PM]	\$600.00
<b>FULL DAY</b> [8AM—6PM]	\$850.00
<b>'NIGHT BEFORE' BUMP-IN</b>	\$150.00
<b>OVERTIME</b> [CHARGED HOURLY]	\$100.00
<b>FRESHLY PAINTED CYCLORAMA</b>	\$200.00

[all pricing includes GST]

Generally 6pm, but call to discuss if you need something different.

Being creatives ourselves, we know things can go over and we will do our best to accommodate that leeway but if your shoot drastically needs more time, this will be charged at \$100 per hour.

Our studio gets used for so many different things and the cyclorama varies from day to day in levels of pristine-ness. Need a fresh coat of paint for your shoot? With 48 hours notice, we will happily arrange this for you.

## SOUND STUDIO/ GREEN ROOM

<b>HALF DAY</b> [8AM—12PM OR 2PM—6PM]	\$350.00
<b>FULL DAY</b> [8AM—6PM]	\$550.00
<b>'NIGHT BEFORE' BUMP-IN</b>	\$150.00
<b>OVERTIME</b> [CHARGED HOURLY]	\$100.00

[all pricing includes GST]

# AVAILABLE EQUIPMENT

---

5x Shotbags

---

6x Polyboards

---

5x C-Stands

---

1x Kupo heavy duty Combo stand with Articulating Superboom

---

Makeup Table with Soft Worklight

---

2x Electric Heaters

---

1x 32A and 1x 20A 3 phase outlets

---



# HOUSEKEEPING

## ENTERING

### LOCKBOX

Since you may be arriving to the studio before our staff arrive, we offer self-entry via a key in the lockbox outside the building. The instructions for this access will be emailed to the main point of contact for your shoot 24 hours prior to the first date of your hire.

### SECURITY CODE

Once the key from the lockbox has been used to access the building, there is an additional alarm box just inside the front door. In the same email (mentioned above), the disarm code for this alarm box will also be sent to you.

### ROLLER DOOR

We have great roller door access from street to the main studio, and we want you to use it! Once you are in the building, and you have followed the signs to the main studio space, there is a readily available roller door with same-level access which allows you to drive gear vehicles straight into the space! Talk about convenient...

### MUSIC

We have a Sonos speaker system available to studio hirers in the main space. In order to access this system, all you need is the Sonos App, or to be connected to iTunes/Spotify whilst on the MB Studios wi-fi network. Instructions for playback will be sent to you as part of your welcome pack.

## EXITING

### WRAP TIME

Generally speaking, we have a hard out of 6pm for studio hires unless otherwise notified or negotiated with the Studio Manager. This allows us to prep the space accordingly for any next-day hires. If your shoot is running over on the day, be sure to notify the Studio Manager so we can try to present flexible options for you.

### LOCKING UP

In the instance that you are bumping out beyond 6pm, you may be granted the option to self-lock-up. This will require the alarm to be enabled, the key to be returned to the lock box and a final check to ensure the roller door and side doors are securely closed. If you are unsure about your lock up scenario, discuss this with the Studio Manager.

### AVAILABLE EQUIPMENT & ADD-ONS

Please check overleaf for a breakdown of the equipment comes as a part of our base studio hire bundle, and what additional hire options can be made available to you upon request.

# LOCAL AMENITIES

Being located in the heart of Brunswick gives us prime access to some of the best and most conveniently located amenities. All the below facilities are within a 10 minute walk from our studio.

## PUBLIC TRANSPORT

**BRUNSWICK TRAIN STATION [UPFIELD LINE]**  
Upfield Shared Path, Brunswick VIC 3056  
4 min walk, 290m

**ALBERT ST/SYDNEY RD #22 BUS [ROUTE 951]**  
5 min walk, 400m

**VICTORIA ST/SYDNEY RD #19 TRAM**  
5 min walk, 400m

## COFFEE

**ALBERT STREET CAFE**  
21/306 Albert St, Brunswick  
[instagram.com/albertstreetcafe](https://www.instagram.com/albertstreetcafe)  
2 min walk, 140m

**PROJECT 281 COFFEE ROASTERS**  
281 Albert St, Brunswick  
[project281.com](https://www.project281.com)  
4 min walk, 270m

**DOJO ESPRESSO**  
314 Victoria St, Brunswick  
[instagram.com/dojoespresso](https://www.instagram.com/dojoespresso)  
5 min walk, 400m

**MARKET LANE COFFEE**  
383 Sydney Rd, Brunswick  
[marketlane.com.au](https://www.marketlane.com.au)  
6 min walk, 450m

## FOOD

**PROJECT 281 COFFEE ROASTERS [BRUNCH/LUNCH]**  
281 Albert St, Brunswick  
[project281.com](https://www.project281.com)  
4 min walk, 270m

**SISTERS [KEBABS/TAKEAWAY]**  
288 Albert St, Brunswick  
[instagram.com/sistersbrunswick](https://www.instagram.com/sistersbrunswick)  
4 min walk, 270m

**GREEN FIELD [VIETNAMESE/ASIAN]**  
376-378 Sydney Rd, Brunswick  
[greenfieldbrunswick.com.au](https://www.greenfieldbrunswick.com.au)  
6 min walk, 400m

**SMALL AXE KITCHEN [BRUNCH/LUNCH]**  
281 Victoria St, Brunswick  
[losamantes.com.au](https://www.losamantes.com.au)  
5 min walk, 350m

**HOTEL RAILWAY [PUB/PIZZA]**  
291 Albert St, Brunswick  
[smallaxekitchen.com](https://www.smallaxekitchen.com)  
3 min walk, 120m

## GROCERIES

**WOOLWORTHS BRUNSWICK**  
300-304 Albert St, Brunswick  
[woolworths.com.au](https://www.woolworths.com.au)  
5 min walk, 400m

**ALDI**  
292/298 Sydney Rd, Brunswick VIC 3056  
[aldi.com.au](https://www.aldi.com.au)  
8 min walk, 600m

## HARDWARE

**BUNNINGS WAREHOUSE**  
415 Sydney Rd, Brunswick VIC 3056  
[bunnings.com.au](https://www.bunnings.com.au)  
7 min walk, 500m

# SAY HI TO THE TEAM

You might know of Monster & Bear as a studio space, but did you know we're a production house and post-production facility too? Working from the Production Office facility in the same building, you may see some of these faces on your travels, so don't be afraid to say hi if you see someone in transit to the shared kitchen and bathroom facilities on your studio hire day!

We also love collaborating with other production companies, so if you ever require production assistance with on site shoots, off site shoots, editing, VFX, animation or sound design, please don't be afraid to hit us up. You can get in touch with us via the Studio Manager (Shannyn Higgins), or via [hello@monsterandbear.com.au](mailto:hello@monsterandbear.com.au).



## PATRICK O'NEILL

### STUDIO MANAGER

An aficionado of the cinematic and photographic arts, Pat's background has previously seen him work in the camera department at the Australian Broadcasting Corporation on such programs as Spicks & Specks, Dirty Laundry Live, and the VFL. No stranger to the logistical pressures of a seamless production, Pat has you covered when it comes to the detailed requirements of your hire with us.

As your primary point of contact for the hiring process, Pat works both on and off site at Monster & Bear, but is always a phone call or email away. He is also your port of call if you'd like to arrange a studio tour prior to your booking. We're extremely fortunate to have Pat helping our hirees through the studio process. And we look forward to having you!





# WHAT WILL YOU USE IT FOR?

[monsterandbearstudios.com.au](http://monsterandbearstudios.com.au)

